

Haltian Radar

Quick Guide

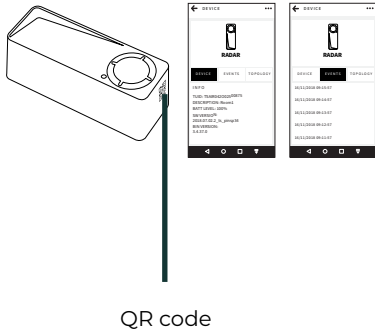

1. Read the QR code to identify the device.



2. Choose your installation spot. For wall or pole installations, the installation height is 40 - 60cm.

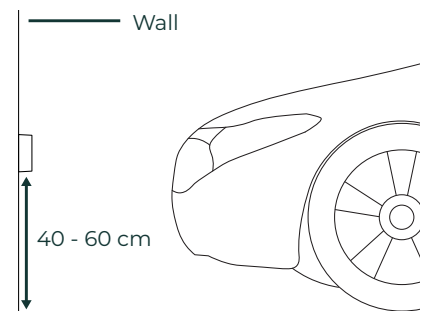

For ceiling installations, the maximum height is 5 meters.

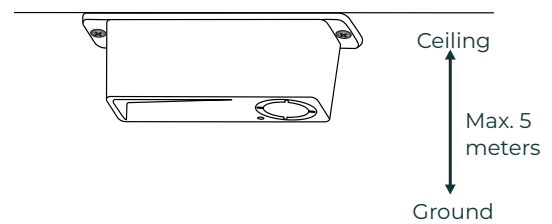

3. **Installation method 1:** Remove the attachment tape's release paper and attach it to the device. Then remove the other release paper and install the device to a clean surface by pushing firmly for 30 seconds.

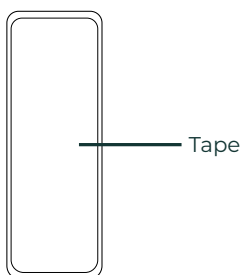

- Installation method 2:** Use the Screw Mount Plate for ceiling installations by first attaching the plate to the device, and then screwing it to the installation surface. Note that the attachment plate is available as an outbox accessory.

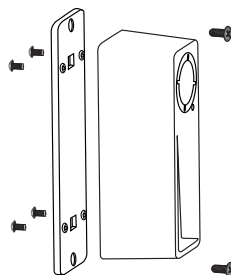

4. Power the device on with the included magnet tool by bringing the magnet close to the device's end with the QR code. The LED will blink rapidly for 30 seconds when the device is ready to use.

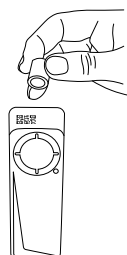

Continue to read the detailed installation instructions.

Watch installation video here



Haltian Radar

User and Installation Guide

v.24.01

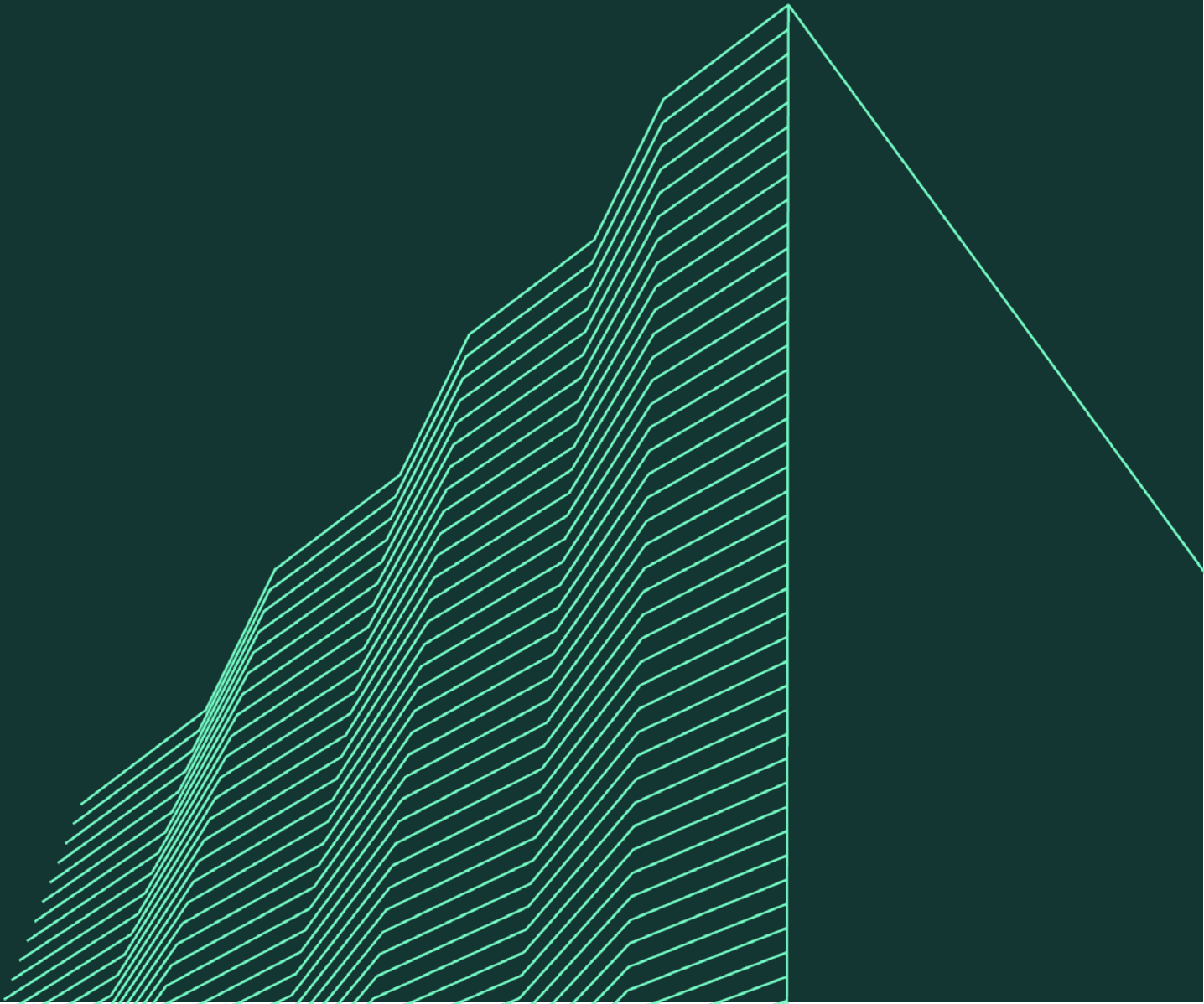

Welcome to using Haltian IoT

We at Haltian want to make IoT simple, so we have created a solution that is easy to use, scalable, and secure. I hope it will help you achieve your business goals!

Pasi Leipälä
CEO, Haltian Oy

Haltian Radar



Haltian RADAR is the most reliable wireless vehicle detection sensor for various facility management use cases, like smart parking and loading dock occupancy detection.

Haltian RADAR is a part of Haltian's IoT solution and product family.

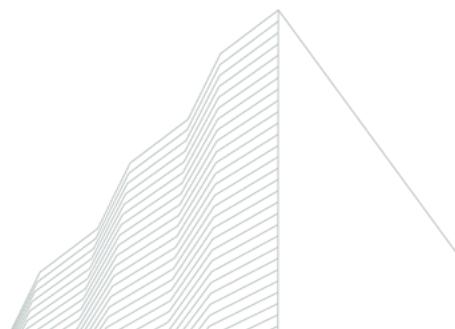

Sales package content

- Up to 5 x Haltian RADAR sensors, depending on the quantity ordered
- Haltian Adhesive tapes, one for each sensor
- 1 x Haltian Sensor Activation Tool for turning the device on

Accessories

- Screw Mount Plate for Haltian RADAR, e.g. ceiling installations using screws. Available as a standalone purchase.

Using Haltian RADAR sensor

Haltian RADAR measures the distance between the sensor and any surface. The sensor sends a 60GHz radio wave signal and calculates the distance from the time it takes for the wave to return to the sensor from an object in the beam area. The strength of the signal is also measured and with these, RADAR can reliably detect changes in the observed area.

Haltian RADAR can be used to detect if a parking space or loading dock is occupied or not. It can also be used to detect any changes in the observed area for other occupancy monitoring use cases.

Haltian RADAR gives reliable occupancy data and it has an adjustable sensing distance, making the installation flexible and easy.

Haltian RADAR is made to function in any environmental conditions inside or outside. The 60 GHz radar detection remains uncompromised by any natural source of interference such as noise, rain, dust, temperature, object color and material, and direct or indirect light.

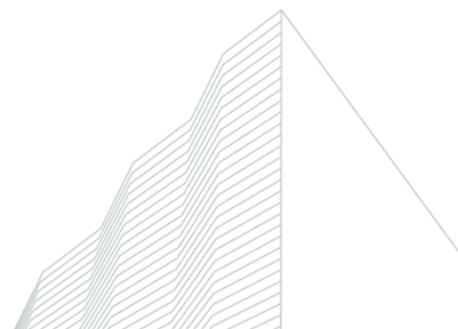

General installation instructions

Install Haltian RADAR sensor in front of or above the space you want to monitor. Make sure that the sensor beam is directed toward the area. Install the device, if possible, perpendicular to the center of the measured area. However, depending on the installation spot, you can also position the device at an angle of up to 45 degrees or more. Ensure that the beam accurately covers the observed area, and adjust the sensing distance to avoid detecting objects beyond the intended monitoring zone.

The best positions for parking place monitoring:

- On the wall or pole in front of the parking space.

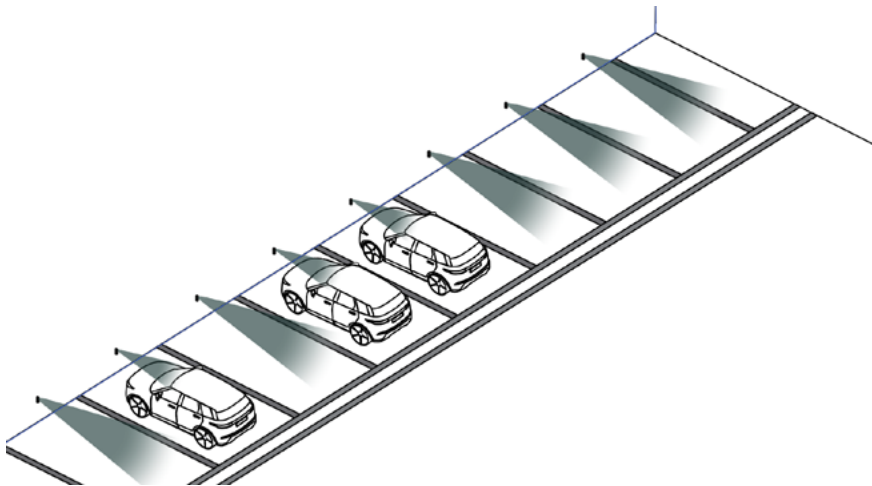

- On the ceiling above the parking space.

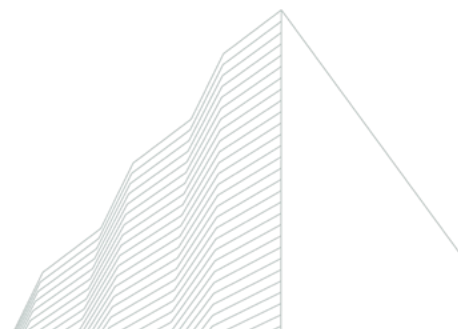
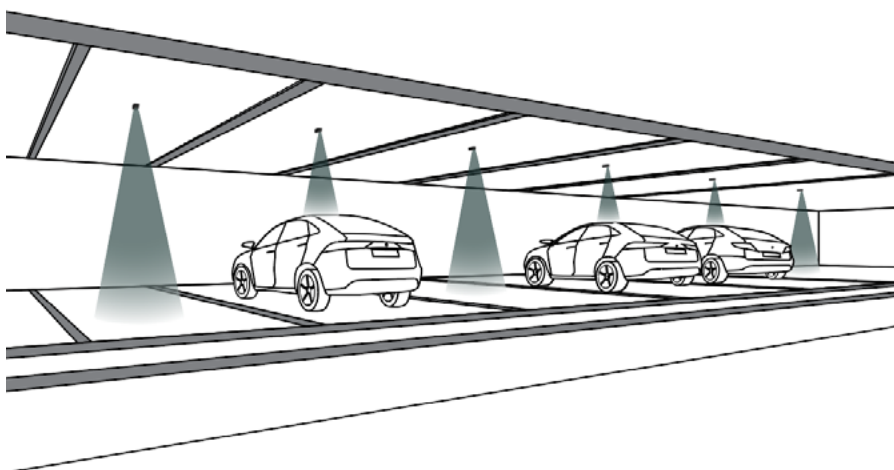

- In poles, angled roughly 45 degrees to towards the observed spot. This is particularly important when installing two sensors on one pole detecting occupancy of two adjacent places.

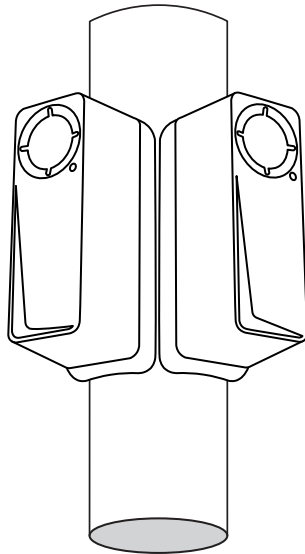

The main thing to consider when choosing the installation method is to ensure a clear view of the detection beam towards the observed area.



Things to avoid in installation

The following can effect the wireless radio communication:

- 1.** Thick concrete structures or thick fire doors.

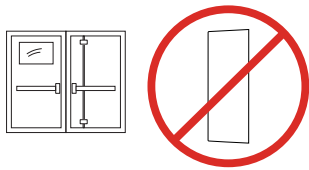

- 2.** Electrical transformers or thick electrical wires.

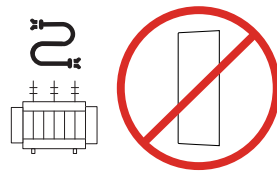

- 3.** Escalators.



- 4.** Nearby halogen lamps, fluorescent lamps or similar lamps with hot surfaces.

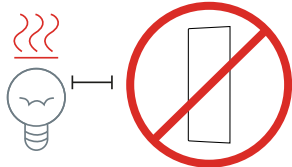

- 5.** Nearby radio equipment like WiFi routers or any other similar high-power RF transmitters.

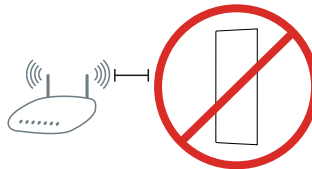

- 6.** Metal objects blocking the signal between other sensors or the gateway.

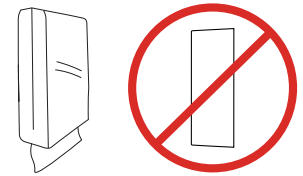

- 7.** Near elevator motors or similar targets causing a strong magnet field.

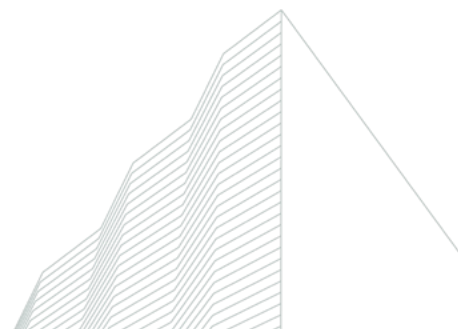
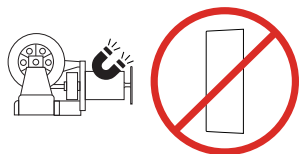

Installation

Please make sure the Haltian gateway device is installed before you install the sensors.

To identify the sensor, read the QR code on the end of the device with a QR code reader or Thingsee Toolbox application on your mobile device.

Identifying the device is not necessary, but it will help you keep track of your IoT installation and help Haltian support to solve possible issues.

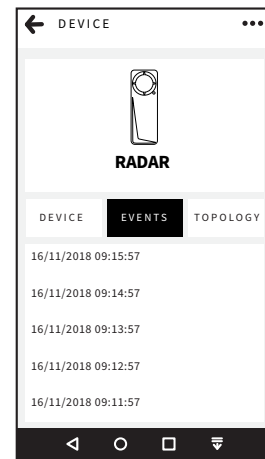
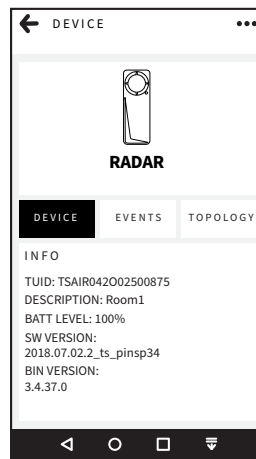
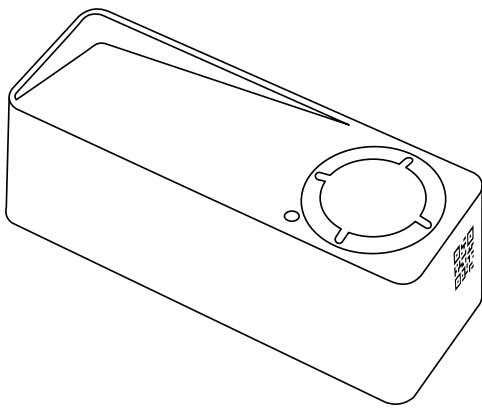

Note: Make sure the sensor is installed max. 20 meters from the next sensor or gateway. This is to ensure a full coverage mesh network between the sensors and the gateway.

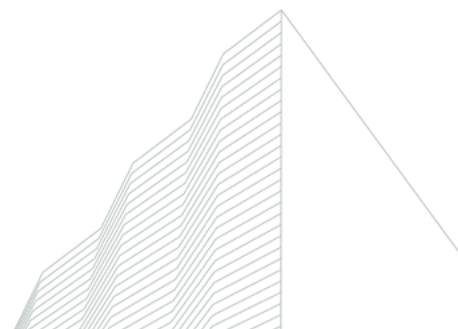

Haltian RADAR is powered on by using a the magnet included. Place the magnet close to the device's end as shown in the picture.

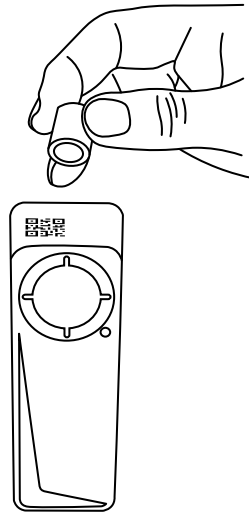

Haltian RADAR has an indication LED that shows the operating status.

Out of the box the device is in deep sleep transport mode indicated with dim green LED blinking every 2 seconds. When the magnet is brought close to the device's end point, the device will indicate start-up by blinking brightly for 15 seconds. Notice that the first boot(before LED starts blinking) may last about 30 seconds if the Radar detects that a newer OTA firmware update is available and automatically downloads it.

LED statuses:

- Deep sleep mode = Quick, dim green LED blink every 2 seconds
- Start-up phase after using the magnet = device blinks brightly for 15 seconds with two-second intervals. Then switches to blink every 15 seconds for a further 10 minutes.
- Device installed and operating = LED off

The status of an installed device can be checked using the magnet:

- Magnet placed on top of the device, Green LED blinks 3 times with 2 seconds intervals = Connection OK
- Magnet placed on top of the device, Green LED blink once = Device on, but connection failed
- Failed connection means there's no Wirepas network available, or no gateway connection exists.



Installation method 1:

Installing Haltian RADAR with attachment tape

The default attaching method in wall installations is using the included attachment tape. First, remove the tape's release paper and attach it to the device. Usually, the tape is attached to the back of the device, but the tape can be attached to the sides as well if the installation requires it.

The recommended installation height in wall installations is 40-60cm from the floor.

Clean the installation surface with IPA -solvent (isopropyl alcohol) to remove any grease, dust, or other from the surface. The smoother the surface the better, but the gel tape allows some unevenness. Please note that the recommended temperature for the tape installation is at least +15 degrees. If the surface is much colder, you can pre-warm it using for example hot air blower/ heat gun, or gas torch if it can be done safely.

Remove the release paper from the other side and press the device firmly against the surface for a minimum of 30 seconds. Test lightly that the device is well attached and there is no excess movement. The tape will reach its full strength in about 24 hours.

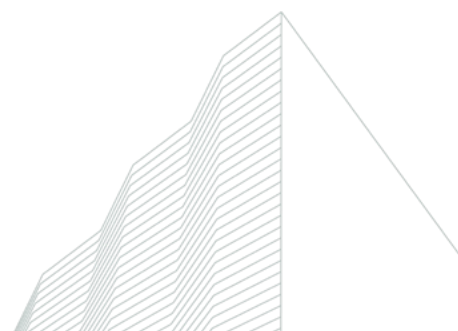
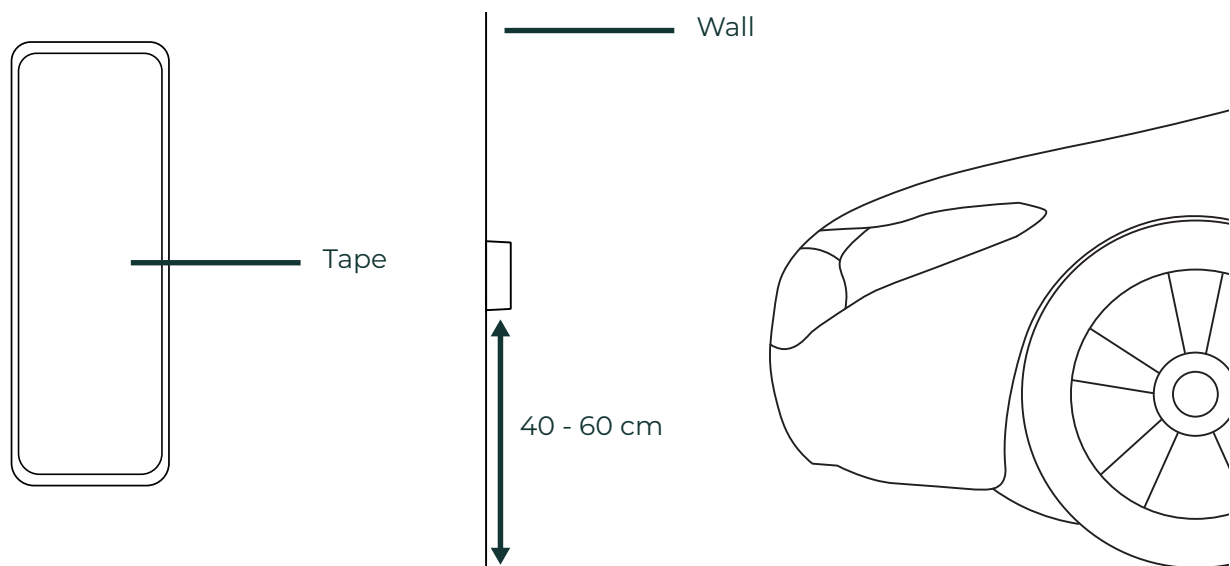

Installation method 2:

Installing Haltian RADAR with Screw Mount Plate (accessory)

If the installation surface is not suitable for tape, you can use the attachment plate accessory available as a standalone purchase. Ceiling installations should always be done with the Screw Mount Plate. Please note that Haltian takes no responsibility for possible damages caused by falling devices.

Attach the plate to the device using the 4 provided screws.

Then use the 2 provided screws to install the device to the planned surface. Screw anchors are also included and can be used if they work on the surface material.

If the ceiling height is more than 3 meters, you may need to adjust the sensing distance (using the Thingsee Toolbox mobile app) to be more than the default 2 meters. The maximum recommended height is 5 meters. It's important to note how the sensing area is impacted by installation height (refer to the Detection Capability chapter below).

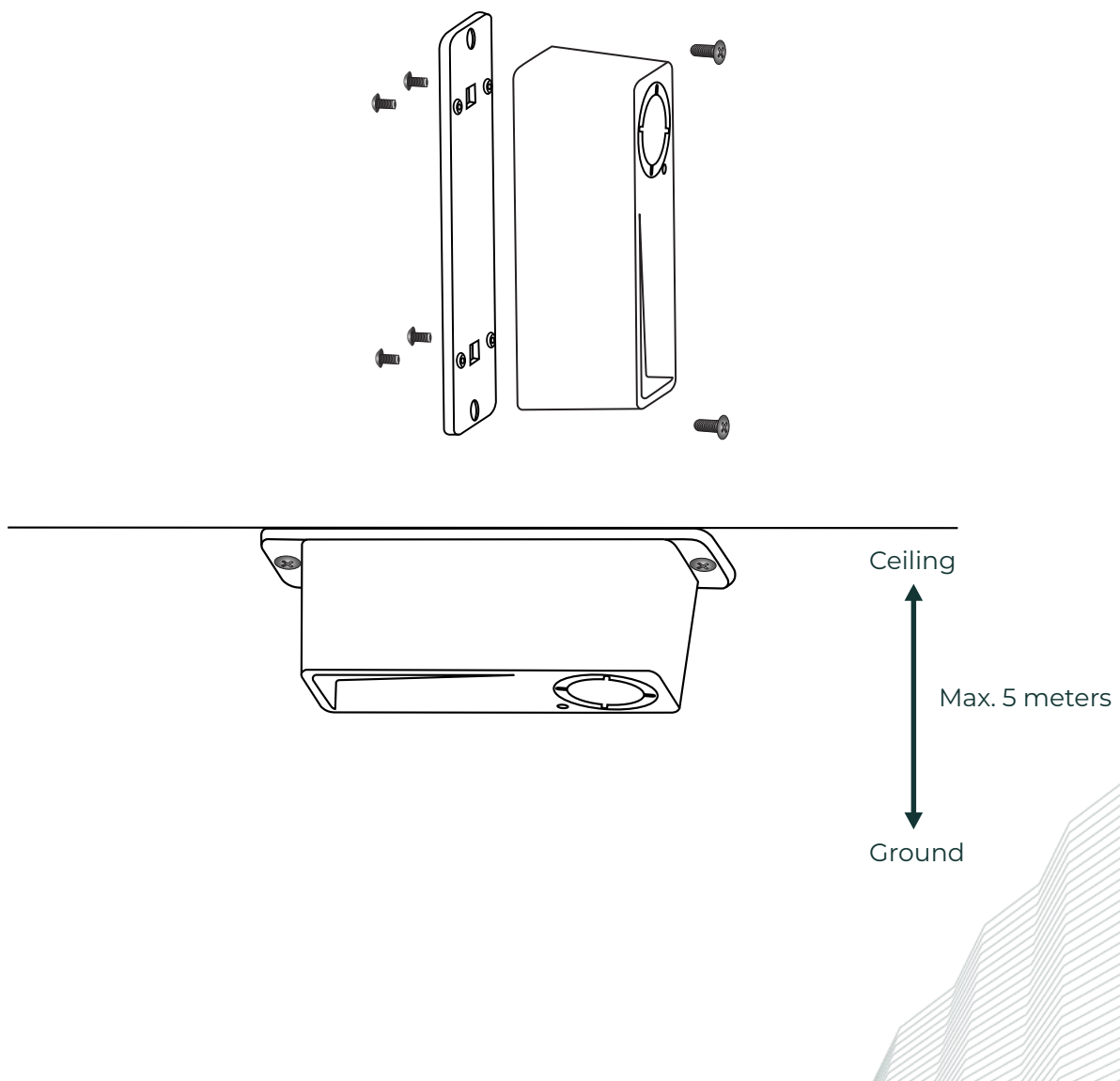

Using Haltian for loading dock monitoring

Haltian RADAR sensor can be used for monitoring the occupancy of loading docks. In the loading dock case, Haltian RADAR is always wall-mounted or mounted to the loading dock frame or structures. The best position is in the middle of the dock, but both sides will work as long as the detecting cone still hits the area to be observed. Make sure that the detection cone does not hit the neighbouring loading area to prevent false positives.

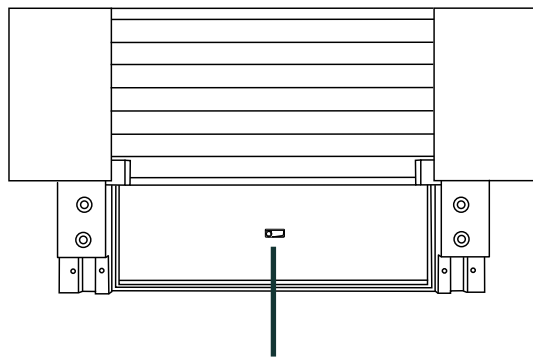

Haltian RADAR sensor

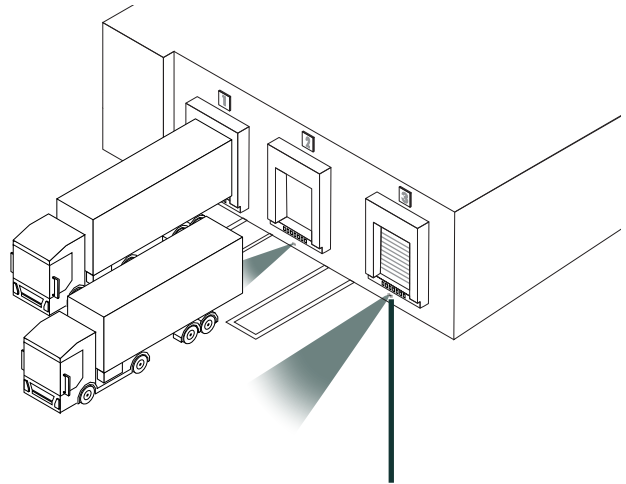

Haltian RADAR sensor

Please check that the installation spot is not impacted by any moving mechanisms in the loading dock during its operation. The RADAR should be installed in a location where it will not be hit or damaged by a truck backing up or approaching the loading dock.

The dock area doesn't need to be free during the installation which makes the installation possible with minimal disruptions to normal warehouse operations. After installation, Haltian RADAR performs an Echo Level Adjustment (ELA) that automatically sets the detection threshold. If the dock is occupied by e.g. a truck during the installation, Haltian RADAR will show the place as free until the truck leaves.

After this the device finds a new lower threshold level and detects the next truck arriving, informing that the place is now occupied.

The ELA process can be also initiated manually using Thingsee Solution Suite application if there are, for example, new fixed structures brought into the observed area (i.e. new safety railings etc.) and those need to be taken out of the threshold. Without running a new ELA process, Haltian RADAR would always detect the structures and show the place as occupied.



Detection Capability

- Measurement range: 120 cm – 10m. Default setting 2 meters.
- Sensing area is a cone shape, 17 degrees, region of interest (ROI).

Default measurement and reporting in parking use case (pre-configured in production)

Default settings:

- Check occupancy every 30 seconds
- Report occupancy value whenever the state changes and every 1 hour even if there is no change
- Report battery level every 24 hours
- Sensing distance 2 meters

The following parameters are configurable remotely over Haltian Operations Cloud:

- Measurement interval
- Sensing distance
- Reporting interval

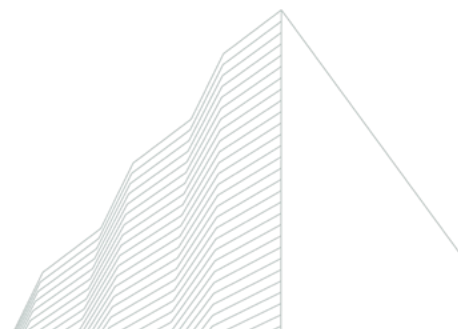
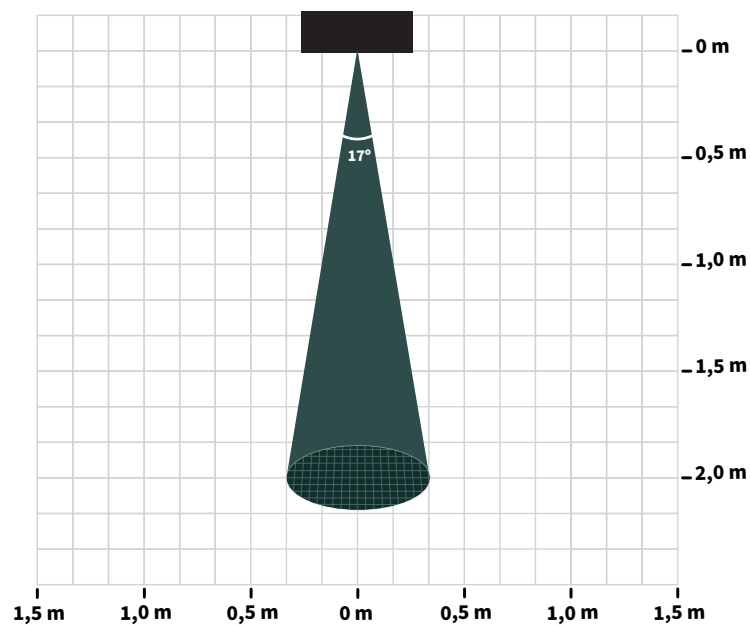

Default measurement and reporting in loading dock use case (pre-configured in production)

Default settings:

- Check occupancy every 60 seconds
- Report occupancy value whenever the state changes and every 1 hour even if there is no change
- Report battery level every 24 hours
- Sensing distance 5 meters

The following parameters are configurable remotely over Haltian Operations Cloud:

- Measurement interval
- Sensing distance
- Reporting interval

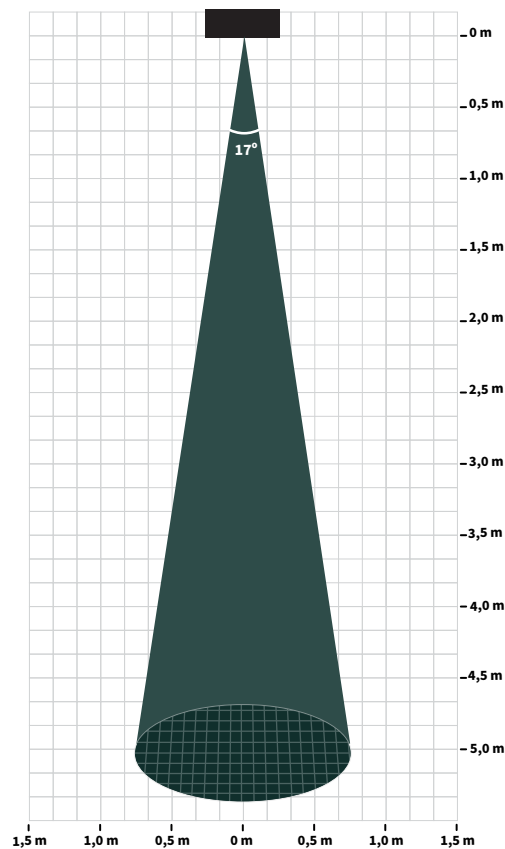

Settings' impact on battery life

- 30min measurement interval up to 25 years
- 1min measurement interval up to 10 years (default setting for loading dock use case)
- 30s measurement interval up to 6 years (default setting for parking use case)
- 10s measurement interval up to 4 years

Device info

Operating temperature -35 °C ... +85 °C

Operating humidity 0 % ... 100 % RH non-condensing

Storage temperature +5 °C ... +25 °C

Storage humidity 45 % ... 85 % RH non-condensing

IP rating grade: IP68

Certifications: CE, UKCA and RoHS compliant

Battery type: Thionyl Chloride Lithium Battery 19Ah, non-user-replaceable

Radio sensitivity: -95 dBm (BTLE)

More device info can be found at support.haltian.com

Device dimensions

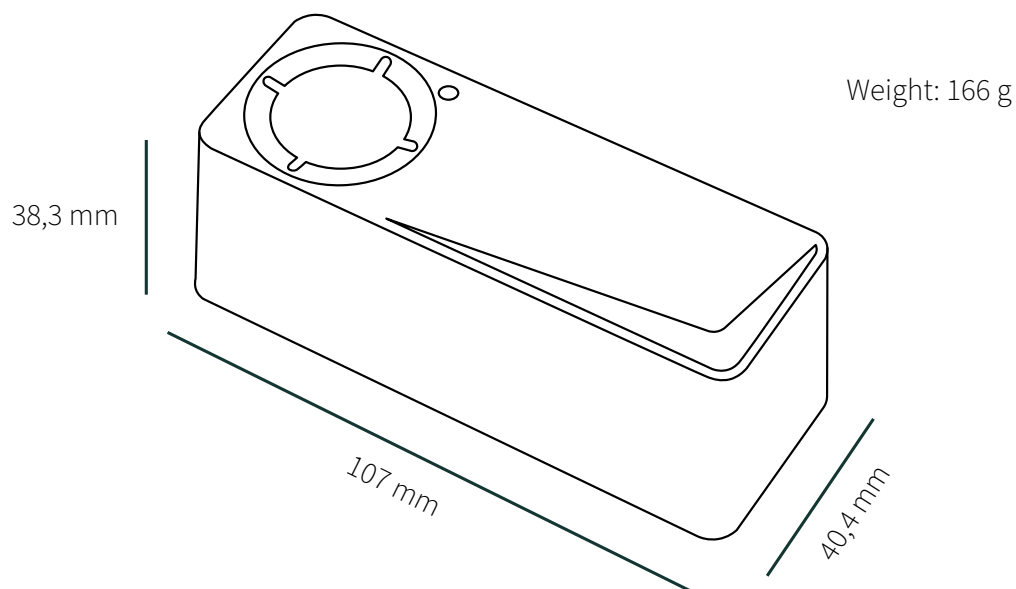

CERTIFICATION INFORMATION EU DECLARATION OF CONFORMITY

Hereby, Haltian Oy declares that the radio equipment DRA is in compliance with Directive 2014/53/EU. The full text of the EU declaration of conformity is available at the following internet address: support.haltian.com

Haltian Oy vakuuttaa, että radiolaitetyyppi DRA on direktiivin 2014/53/EU mukainen. EU vaatimustenmukaisuusvakuutuksen täysimittainen teksti on saatavilla seuraavassa internetosoitteessa: support.haltian.com

Hereby, Haltian Oy declares that the radio equipment type DRA is in compliance with the UK relevant statutory requirements (Radio Equipment Regulations 2017 (SI 2017 No. 1206)). The full text of the declaration of conformity is available at the following internet address: support.haltian.com

Haltian RADAR operates at Bluetooth® 2.4 GHz frequency band. Maximum radio-frequency power transmitted is +4.0 dBm.

Manufacturer name and address:

Haltian Oy
Yrttpellontie 1 D
90230 Oulu
Finland

SAFETY GUIDE

Read these simple guidelines. Not following them may be dangerous or against local laws and regulations. For further information, read the user guide and visit www.haltian.com

Usage

- Do not open or disassemble the device.
- Do not modify the device. Unauthorized modifications may damage the device and violate regulations governing radio devices.
- Disposal of the device into fire or a hot oven, or mechanically crushing or cutting of the device can result in an explosion
- Leaving the device in an extremely high temperature surrounding environment can result in an explosion or the leakage of flammable liquid or gas
- The device subjected to extremely low air pressure may result in an explosion or the leakage of flammable liquid or gas
- Please take care that the used devices are recycled by taking them to appropriate collection point.
- Keep devices away from children.

Care and maintenance

Handle your device with care. The following suggestions help you keep your device operational.

- Unauthorized modifications may damage the device and violate regulations governing radio devices.
- Avoid to drop, knock, or shake the device. Overtly rough handling can break it.
- Use a soft cloth to clean the surface of the device. Do not clean the device with solvents, toxic chemicals or strong detergents as they may damage your device and void the warranty.

Damage

If the device is damaged contact support@haltian.com. Only qualified personnel may repair this device.

Small children

Your device is not a toy. It may contain small parts. Keep them out of the reach of small children.



RECYCLING

Check the local regulations for proper disposal of electronic products. The Directive on Waste Electrical and Electronic Equipment (WEEE), which entered into force as European law on 13th February 2003, resulted in a major change in the treatment of electrical equipment at end-of-life. The purpose of this Directive is, as a first priority, the prevention of WEEE, and in addition, to promote the reuse, recycling and other forms of recovery of such wastes so as to reduce disposal.

The crossed-out wheelie-bin symbol on your product, battery, literature, or packaging reminds you that all electrical and electronic products and batteries must be taken to separate collection at the end of their working life. Do not dispose of these products as unsorted municipal waste: take them for recycling. For info on your nearest recycling point, check with your local waste authority.

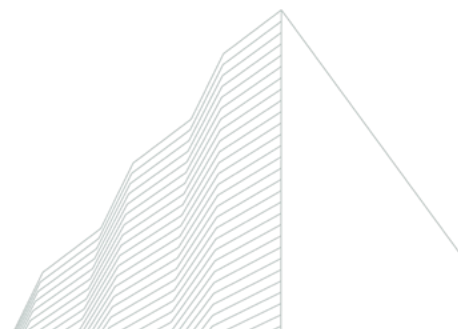

Get to know all our Haltian devices



Thingsee
PRESENCE



Thingsee
ENVIRONMENT



Thingsee ENVIRONMENT
RUGGED



Thingsee LEAKAGE
RUGGED



Thingsee
AIR



Thingsee
BEAM



Thingsee GATEWAY
GLOBAL



Haltian
RADAR

For all devices and more information, visit our website
www.haltian.com or contact sales@haltian.com

